

# **Naiyala Repeater Site Civil Works**



**MR 91/2018**

**Naiyala Repeater Site Civil Works**

## **1.0 THE COMPANY – FEA**

The supplying of power throughout the Fiji Islands is the responsibility of the Fiji Electricity Authority (FEA) which is a government owned company. Power is supplied through Hydro, Diesel and wind mill generators located in different parts of Fiji.

There are three geographical divisions in which the company operational work is organized. These divisions are:

- Central Eastern Division based in the capital Suva
  - Suva, Lami, Navua, Tailevu, Levuka and part of the Coral Coast
- Wertern/Nothern Division based in Lautoka
  - Lautoka, Tavua, Ba, Sigatoka, Vatukoula
  - Northern Division (Labasa, Savusavu)

## **2.0 Purpose and description of the Tender**

The Fiji Electricity Authority (FEA) is requesting for bids from reputable Companies for the Civil Works to the newly developed **Repeater Station** in Naiyala, Tailevu along Vunidawa road towards Tonia village.

## **3.0 Scope of Works**

The work shall be carried out at Naiyala, Tailevu – *Naiyala Repeater Access Road*, and shall comprise of the following:

### Construction of the Naiyala Access Road:

- a) To clear and level the top of the ridge to accommodate the triangular standalone tower and buildings, (equipment room and toilet) with a dimension of 87.33m by 41.71 by 20.33m (Appendix 2 - Google Earth Snapshot).
- b) To construct 6m wide PWD standard country access road, spread gravel and to compact newly laid gravel road base materials.
- c) To spread river gravel and compact the length and width of the road.
- d) To crown the access road adequately to allow water to drain off the road surface.
- e) To upgrade all side drains and create new cut off drains where necessary.
- f) To clean the full length of road verges/shoulders.
- g) To provide sufficient natural earth drainage on the sides of the road wherever required.
- h) To provide and install 450mm diameter culverts at the junction of the Naiyala - FEA access road. Provide and install headwalls on either sides of the culvert.
- i) The site is to be left in clean and tidy condition after construction works.

#### 4.0 Repeater Site

- i) To cut and level a site of 87.33m by 41.71 by 20.33m size at the location identified in the Appendix 2 (Google Earth Snapshot) and/or identified by FEA representative during the site visit.
- ii) To provide side drains around the site as necessary (and create cut off drains where required).
- iii) To spread river gravel and compact the length and width of the site, to provide sufficient bearing capacity for the construction of a communication hut.
- iv) To provide sufficient natural earth drainage on the sides of the site wherever necessary.
- v) The site is to be left in clean and tidy condition after upgrading works.

Specifications and Extra Notes: (instructions to be followed wherever applicable or as identified by FEA site rep)

##### i. River Gravel

The Authority's Civil Engineers approval shall be obtained prior to the using of any proposed river gravel. The river gravel shall be well-graded gravel to enable good compaction. River gravel with any clay or silt will not be accepted.

##### ii. Placement of River Gravel

No river gravel shall be placed until approval has been obtained from the Authority's Civil Engineers. *Placing of the river gravel will not be permitted if the formation is too wet following or during heaving rainfall.* River gravel shall be placed in a single layer of 100mm.

##### iii. Compaction of River Gravel

Compaction by a suitable truck or machine will be acceptable but shall be subject to the Authority's Civil Engineers approval. All compaction work over full width and forming appropriate superelevation of the road shall be to the satisfaction of the Authority's Civil Engineers.

##### iv. Crowning and Trimming

The crowning and trimming of the finished work all along the full length of the road with appropriate superelevation shall be done using a road grader.

##### v. Cleaning Up

The site is to be left in a clean and tidy condition after construction works.

##### vi. Time Line

To provide a specific time line to complete the work on site clearance and construction of access road to the repeater site.



vii. Site Visit

The bidders are to meet on Monday, 05/03/18 at 9.00am at the ICT building in Kinoya for the site visit to the actual site in Naiyala, Tailevu. All bidders will have to provide their own transport to ICT Kinoya and to the site at Naiyala, Tailevu.

**5.0 Cost Details**

Bidders shall use the table below to list the item with its associated cost.

<b>Work</b>	<b>Describe how the work will be done</b>	<b>QTY</b>	<b>Unit Price, (FJ \$) VIP</b>	<b>Total Price, (FJ \$) VIP</b>
To clear and level the top of the ridge to accommodate the triangular mast and buildings, (equipment room and toilet) with a dimension of 87.33m by 41.71m by 20.33m (Appendix 1).				
To construct 6m wide PWD standard country access road, spread gravel and to compact newly laid gravel road base materials.				
To spread river gravel and compact the length and width of the road.				
To crown the access road adequately to allow water to drain off the road surface.				
To upgrade all side drains and create new cut off drains where necessary.				
To clean the full length of road verges/shoulders.				
To provide sufficient natural earth drainage on the sides of the road wherever required.				
To provide and install 450mm diameter culverts at the junction of the Naiyala - FEA access road. Provide and install headwalls on either sides of the culvert.				

**Note:** Clearly state the duration of time to complete the work.

**Specification:**

12.3 General Requirement – Material supplied and installation

- a). Warranty – not less than 12 months
- b). Services provided to be of high standard.
- c). Work done as per the details provided.
- d). After service and support.

**6.0 Eligibility / Selection Criteria of the Bidder**

The bidder shall be a contractor who is qualified, well versed and trained for civil works and in particular communication repeater site civil works with prior experience in similar works.

The vendors shall submit the names/contacts, references of local companies, utilities or projects where they have previously undertaken the work which are similar in nature.

**A detailed information regarding how the bidder is going to carry out the civil works shall be clearly outlined.**

**7.0 Bidder Details**

The Bidder shall provide all the necessary information specified in the tables below:

<b>General</b>
<b>The registered name of the Bidder:</b>
<b>Business address for correspondence:</b> <i>(Location, Street , Locality City, Pin Code, Country, Telephone, Facsimile, Email Other)</i>
<b>Contact name of the Authorised Person:</b>
<b>Contact’s position:</b> <b>Contact addresses if different from above</b> <i>Locality City, Pin Code</i> <i>Location, Street, Country, Telephone, Facsimile, Email, Web address</i>
<b>Business structure:</b>
<b>Include the organisations years of experience in this field and reputation in the market place.</b>
<b>Financial standing</b> (Information designed to give client confidence in the financial competence of the BIDDER.) Audited financial accounts for past three years shall be included in appendix.

<b>Total Employees:</b>			
Sales Total	2014	2015	2016
Net Profit before Tax	2014	2015	2016
<b>Company Profile(s)</b>			
Reference Sites.			
[Details of at least <b>two</b> similar Projects in the last 5 years (including contact details) which will demonstrate the Bidder ability to carry out the functions for this project in a timely and professional manner]			

### **8.0 Other value added services**

The bidder is open to include any other information that may add value to their product or after sales services.

### **9.0 Technical Support**

1. Bidder should provide details of what technical support is available to FEA to make better use of supplier’s product.

### **10.0 Product Information**

Bidders must include the following document together with their Bid:

- Relevant Service Specification recently provided.
- Relevant Test Certificates where applicable.
- Standard Compliance Certificate where applicable.

### **11.0 Defects warranty period**

All goods/service shall be supplied with a Warranty Period of not less than 12 months from the date of the receipt of the Goods/Service by FEA. During the Warranty Period, defective portion of the work shall be done in the correct standard as originally expected.

### **12.0 Price Validity**

The price shall remain valid for acceptance within 3 months from the date of opening of bids and bidders shall not withdraw or amend their proposal prior to the expiration of the validity period. In exceptional circumstances prior to expiry of the original validity period, the Authority may request the supplier for an extension in the period of validity. The request and the response thereto shall be in writing. A supplier agreeing to the request will not be permitted to amend his tender price.

### 13.0 Payment Terms

FEA shall pay the invoice amount in foreign currency to the overseas bank account nominated by the successful supplier within 30 days of receipt of the invoice subject to the materials being received in good order and condition for overseas bidders. The local bidders will be paid in Fijian dollars.

### 14.0 Tender Evaluation

After the bids are received, it will go through a normal tender evaluation process as per FEA’s Tender Policy and Procedures. The successful and unsuccessful bidders will be advised of the outcome after completion of the Tender evaluation process.

The successful bidder will enter into a contract with FEA as mutually agreed. All terms & condition, and pricing details will be stipulated in contract documents.

The evaluation of the tender submissions will be weighted as such:

No.	Components	Weighting (%)
1	Financial Components	40 %
2	Technical capability	35 %
3	Delivery timeframe	15 %
4	Proven background on repeater station equipment & Accessories	10 %

## **15.0 Submission of Tenders**

### **Local Bidders**

**Two (2) hard copies of the tender bids in sealed shall be deposited in the tender box located at the Supply Chain Office at the FEA Head Office, 2 Marlow Street, Suva, Fiji.**

Each tender shall be sealed in an envelope with:

a). The envelope bearing only the following marking:

**Tender – MR 91/2018 Naiyala Repeater Site Civil Works.  
The Secretary, Tender Committee  
Fiji Electricity Authority  
Supply Chain Office  
Private Mail Bag  
Suva**

b). It must also indicate the name and address of the tenderer on the reverse of the envelope.

Tenders received after **4:00pm** on the closing date of **Wednesday 14<sup>th</sup> of March, 2018** will not be considered.

Lowest bid will not necessarily be accepted as successful bid.

**All late tenders, unmarked Envelopes and envelopes without bidder's name and address on the reverse will be returned to the Tenderers.**

For further information or clarification please contact our Supply Chain Office on phone **3224360 or 9991587.**





### 16.0 Check List for Submission of Tenders

In order to confirm that the tender application is fully and completely filled, please refer to the check list on the table below:

#### TENDER FORM

The following information has to be filled by the bidder and submitted with Tender Documents:

1. Company Name: \_\_\_\_\_
2. Director/Owner(s): \_\_\_\_\_
3. Postal Address: \_\_\_\_\_
4. Email Address: \_\_\_\_\_
5. Phone Number: \_\_\_\_\_
6. Fax Number: \_\_\_\_\_
7. Office Location: \_\_\_\_\_
8. Facsimile & Skype: \_\_\_\_\_
9. Web Address: \_\_\_\_\_
10. After Sales Contact details: \_\_\_\_\_  
\_\_\_\_\_
11. TIN Number (local bidders only): \_\_\_\_\_
12. Company Registration Number(local bidders only): \_\_\_\_\_
13. FNPF Employer Registration Number (local bidders only): \_\_\_\_\_
14. Number of Branches & locations: \_\_\_\_\_
15. Years of Experience: \_\_\_\_\_
16. Area of business Specialization:
 

<input type="checkbox"/>	Manufacturer & Supplier
<input type="checkbox"/>	Retailer
<input type="checkbox"/>	Licensed Agent
<input type="checkbox"/>	Others, please specify _____

I hereby, declare that all the above information is correct.

Sign: \_\_\_\_\_

Position: \_\_\_\_\_

Name: \_\_\_\_\_

Date: \_\_\_\_\_

**General Requirement**

#	<u>Task:</u>	Please Tick (✓)	Further comments
i).	To clear and level the top of the ridge to accommodate the triangular mast/tower and buildings, (equipment room and toilet) with a dimension of 87.33m by 41.71m by 20.33m (Appendix 2).		
ii).	To construct 6m wide PWD standard country access road, spread gravel and to compact newly laid gravel road base materials.		
iii).	To spread river gravel and compact the length and width of the road.		
iv).	To crown the access road adequately to allow water to drain off the road surface.		
v).	To upgrade all side drains and create new cut off drains where necessary.		
vi).	To clean the full length of road verges/shoulders.		
vii).	To provide sufficient natural earth drainage on the sides of the road wherever required.		
viii)	To provide and install 450mm diameter culverts at the junction of the Naiyala - FEA access road. Provide and install headwalls on either sides of the culvert.		
ix)	Clearly state duration of time to complete the work.		
x)	Completely fill the tender form.		

**Appendices:**

1. Google Earth image of location of site.
2. Site layout.

**1. Google Earth image of location of site**



## 2. Site layout

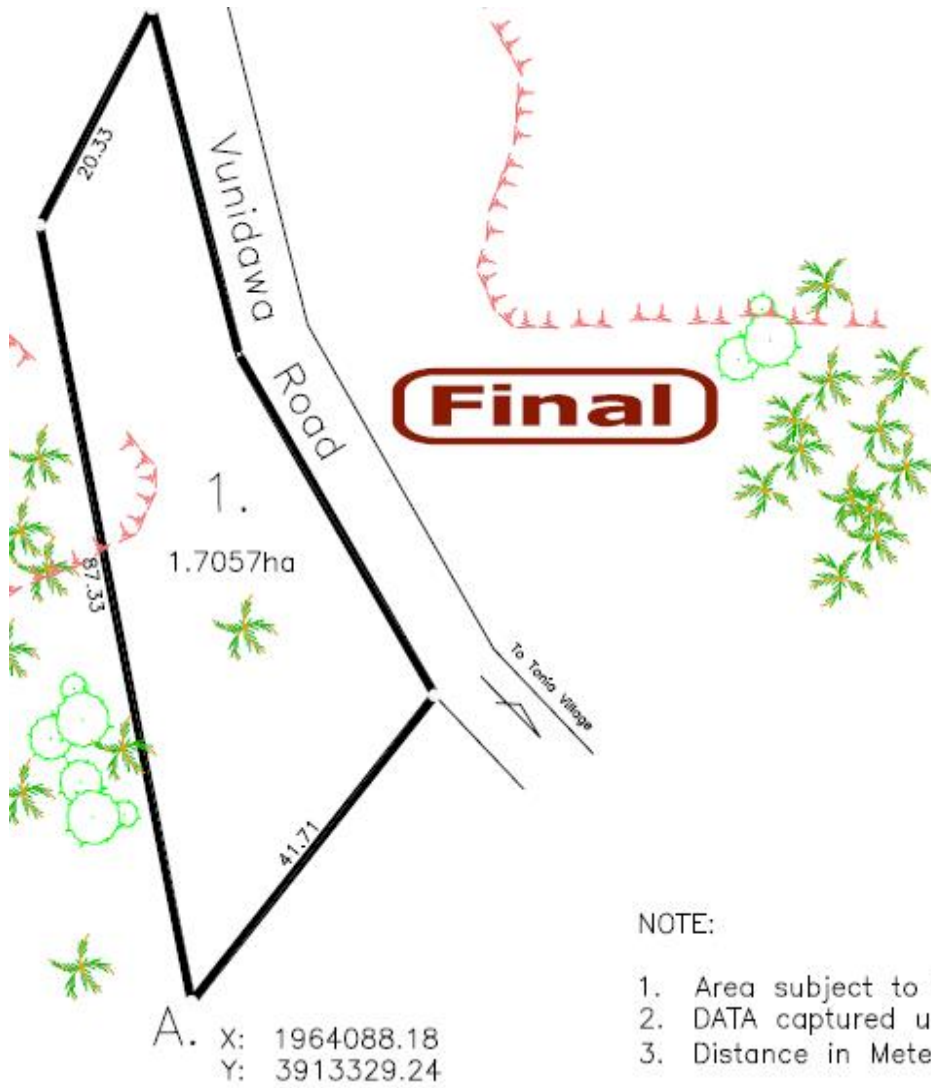

LOCALITY PLAN.  
(NTS)

### NOTE:

1. Area subject to FINAL SURVEY
2. DATA captured using GPS
3. Distance in Meters unless/otherwise stated